

MONROE

Adjustable Handle Quick Guide



Everything you need to know all in one place!

Adjustable Handles



Monroe offers a variety of different adjustable handles. If you don't see what you are looking for, we can custom make anything to your specifications.

Adjustable handles are commonly used where fastening, unfastening, and adjusting becomes difficult because of tight or awkward spaces. Engineered and manufactured to strict standards, we have adjustable handles for about any commercial or industrial use.

We are Monroe!
How can we help?

Our adjustable handles are available in several materials including: plastic, stainless steel, zinc and steel.

Many of our adjustable handle assemblies are available with metric or imperial threads and with steel or stainless steel inserts.

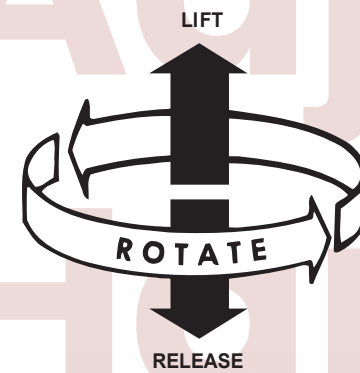

LIFT - You are able to disengage the internal splines while the tapered insert remains stationary, allowing you to rotate the handle to the desired position.

RELEASE - The internal conical spring returns the handle to re-engage the splines for tightening or loosening.

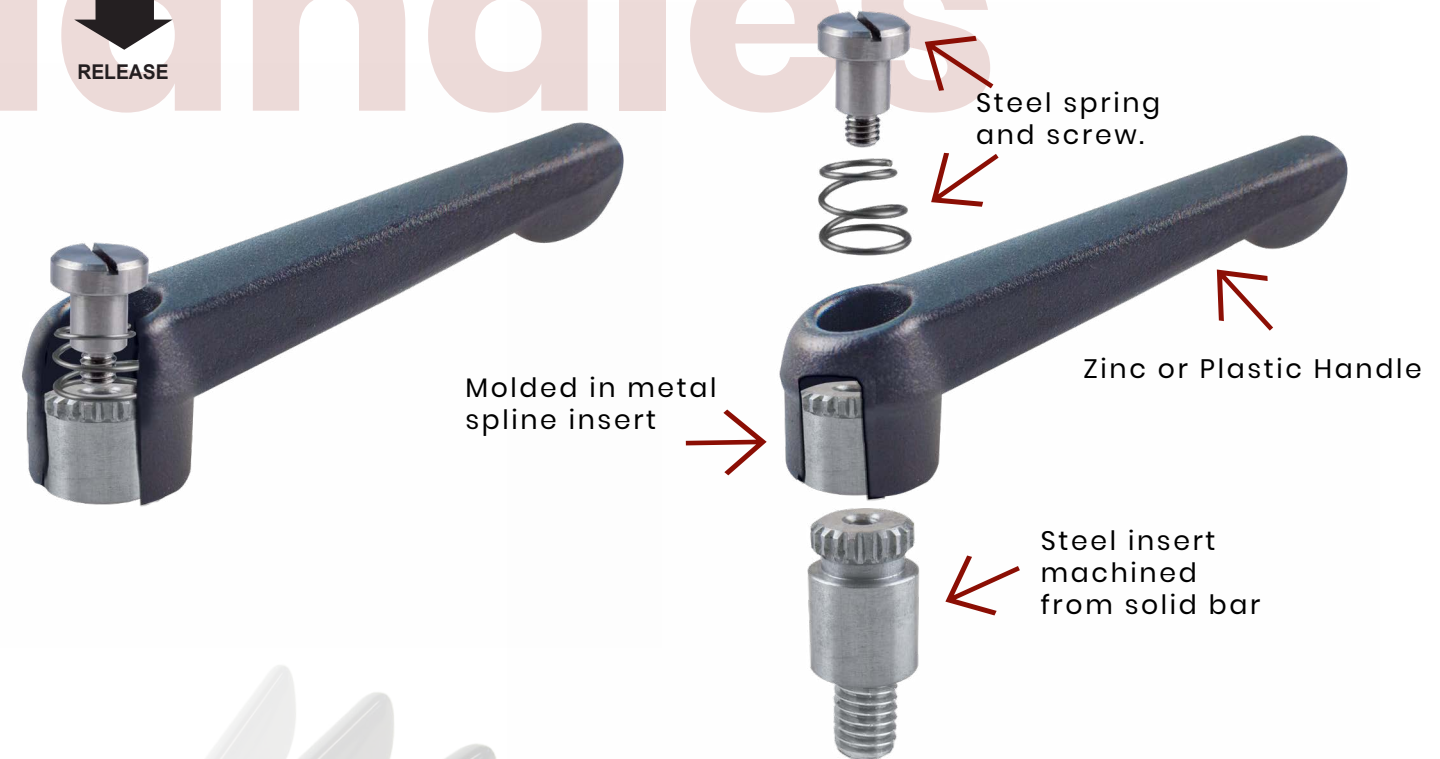

78
CATEGORIES

1524
SKUS

Styles

Monroe offers a variety of different style adjustable handle for any application. Monroe also offers custom capabilities for those with special requirements.

Stainless Steel Ball Style



- Handle material available in die-cast zinc or PA6 thermoplastic
- Insert, screw & spring made from 303 stainless steel
- Instantly adjustable to 20-45 different handle positions depending on size
- Handle color is black (orange available as special order)
- Now available in 100% solid stainless steel version
- Adjustable handle elite design

Zinc Ball Style



- Handle material is die-cast Zinc
- Smooth, comfortable, ball style design with beautiful black gloss powder coated finish
- Insert, screw & spring are made from carbon steel
- Instantly adjustable to 20-45 different handle positions depending on size
- Handle color is black (orange is available as special order)

Heavy Duty



- Solid steel heavy duty adjustable lever is made from carbon steel with high quality black oxide finish
- Totally enclosed construction
- Black plastic ball knob on handle end for a beautiful finished appearance
- 5 heavy duty sizes to meet every need

Plastic Teardrop



- Handle material available PA6 thermoplastic
- Stud, screw & spring made from 303 stainless steel
- Instantly adjustable to 20-45 different handle positions depending on size
- Handle color is black (orange available as special order)
- Now available in 100% solid stainless steel version
- A standard clamping lever that also has an adjustable feature
- Five sizes to fit a wide range of applications
- Special tap/reams are also available on request

Stainless Steel Teardrop

- All components made from 300 grade stainless steel
- Instantly adjustable to 20-45 different handle positions depending on size
- Solid cavity free design
- Bright mirror-like polished finish
- Insert - machined from 1 piece solid bar



Zinc Teardrop

- Handle material available in die-cast zinc or PA6 thermoplastic
- Stud, screw & spring made from 303 stainless steel
- Instantly adjustable to 20-45 different handle positions depending on size
- Handle color is black (orange available as special order)
- Now available in 100% solid stainless steel version
- A standard clamping lever that also has an adjustable feature
- Five sizes to fit a wide range of applications
- Special tap/reams are also available on request



Button Head

- Suitable when turning angle is limited
- Lift lever to disengage clamping device
- Release lever the return spring automatically engages
- Comfortable lever releases
- Resistant to solvents, oils, greases, and other chemical agents
- ELESA® original design



Styles

Specs

Mounting Types

- Pilot
- Reamed
- Stud
- Tapped
- Threaded

1/4-20	M5
5/16-18	M6
3/8-16	M8
1/2-13	M10
5/8-11	M12
3/4-10	M16
10-24	M20
10-32	M24

Thread

Specs



ATS Machine Safety Solutions

ATS Machine Safety Solutions is a in-house design and manufacturing company of industrial machine guards. When it comes to safety, ATS does not cut corners. Their impressive collection of machine guards needed industrial strength angled adjustable handles that were user-friendly and top quality. Monroe was happy to help with a variety of handles for their machine guards.

In the picture to the left you can see their Universal Mount Milling/Drilling Machine Guard. ATS Machine Safety Solutions offers a wide variety of guards and products that allow operators to complete their tasks and most importantly remain safe.

Check them out atssafety.com.

Angles

At times the need for adjustable handles to be placed in a confined space is unavoidable for the application to work correctly. In this circumstance angled handles allow operators to perform the functions they need in the limited space they have. Our heavy duty adjustable handles are not only built to last, but they are available in 0° or 15°.

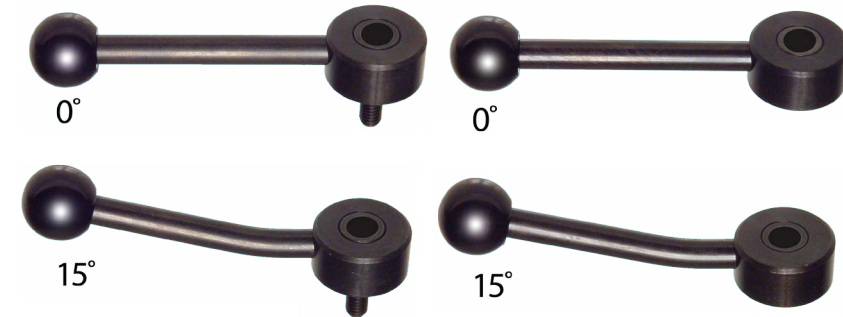

Handle

Our handle and stud length come in both inches and millimeters.

Handle Length

Inches (in)	Millimeter (mm)
1.55	40.00
2.35	65.00
2.50	80.00
2.55	81.00
3.15	95.00
3.20	98.00
3.75	102.00
3.90	110.00
4.00	118.00
4.35	131.00
4.65	136.00
5.15	163.00
5.35	

Handle Material

- STEEL
- CARBON STEEL
- 300 STAINLESS STEEL
- 303 STAINLESS STEEL
- ZINC
- PLASTIC
- PA6 THERMOPLASTIC
- GLASS FIBER
- TECHNOPOLYMER

Stud, Spring, & Screw Material

- BRASS
- STEEL
- CARBON STEEL
- BLACK OXIDE FINISH
- 303 STAINLESS STEEL

Stud Length

Inches (in)	Millimeter (mm)
0.40	10.00
0.50	15.00
0.60	16.00
0.75	20.00
0.80	25.00
1.00	30.00
1.20	35.00
1.25	40.00
1.26	45.00
1.30	50.00
1.40	60.00
1.50	90.00
1.55	
1.60	
1.75	
1.95	
2.00	
2.20	
2.35	

Stud



Advantages & Disadvantages

Figure out what handle material will work best for you!

Cast Zinc



Advantage	Disadvantage
<ul style="list-style-type: none"> Zinc cast offers high strength and low cost Zinc cast gives adequate corrosion resistance for low wear or inside applications 	<ul style="list-style-type: none"> Zinc coating can wear off in high use or maritime applications exposed to salt



Stainless Steel

Advantage	Disadvantage
<ul style="list-style-type: none"> Consistent bright appearance Non-magnetic Has outstanding durability Can be used in Maritime or corrosive manufacturing environments Resists heat affect 	<ul style="list-style-type: none"> Highest cost Heavy compared to the other handles

Plastic



Advantage	Disadvantage
<ul style="list-style-type: none"> Cost wise it is more affordable High impact 175° F to 195° F Fiberglass reinforced 265 to 300° F Will not corrode 	<ul style="list-style-type: none"> Not as strong and durable as metal Best used in light duty applications



Finishes

Monroe offers a variety of different finishes that are sure to fit any need. If you would like a different finish just let us know and we will make it happen.

- Polished black gloss
- Black oxide finish
- Polished finish
- Gray matte finish
- Black matte finish
- Orange color in RAL 2004 (special order)



Polished black gloss



Black oxide finish



Polished finish



Gray matte finish



Black matte finish



Orange color in RAL 2004 (special order)

Finishes

KESSLER CRANE

Kessler Crane is an industry leading manufacturer of innovative tools for filmmakers including: camera cranes, camera motion control systems, camera sliders and dollies, and other camera mounting and grip accessories.

When asked for an adjustable handle that was lightweight and durable for their equipment Monroe knew they could deliver. With a matte black finish their new Kessler TLS is ready to share filmmakers journeys. Check them out at kesslercrane.com.

